

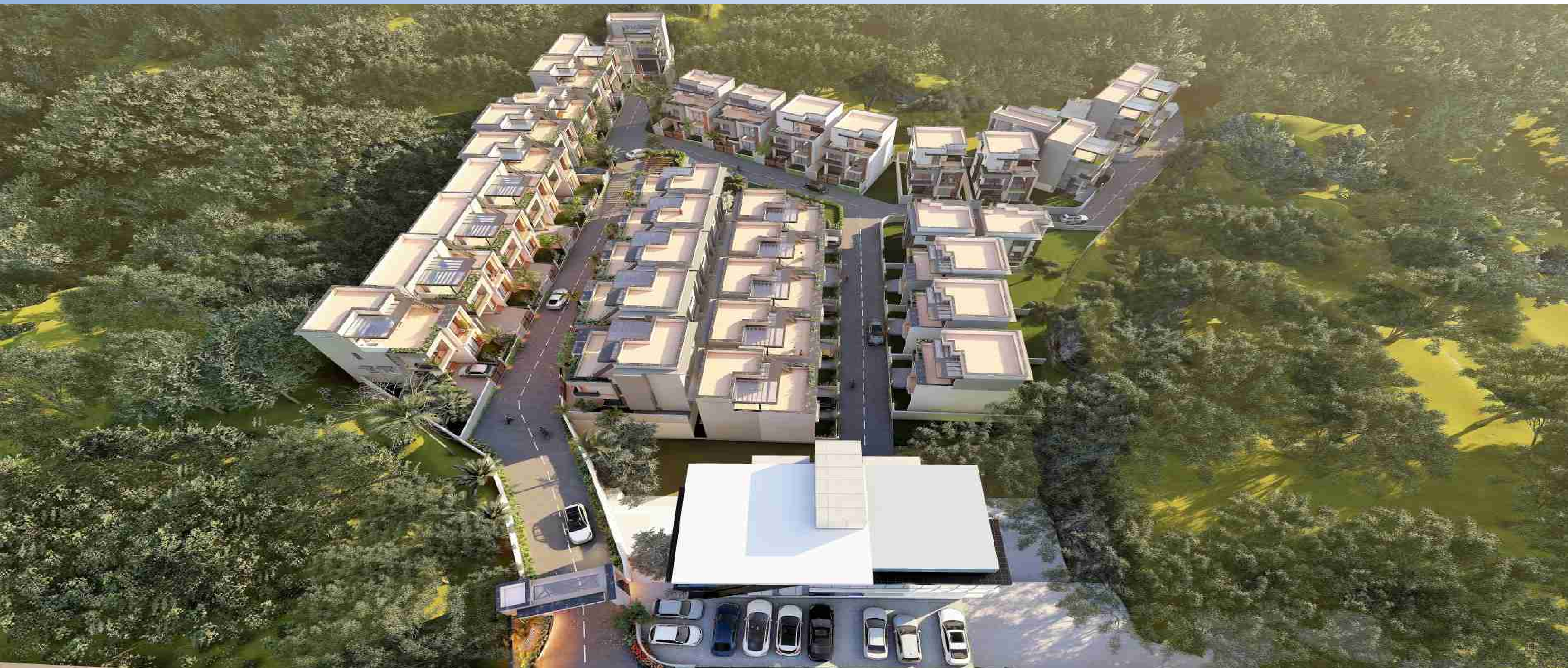

Grihalaxmi Realty Ltd.

# **BUY PLOTS OR PLOTS WITH HOME**

## **New Launch on Sale**



Peaceful  
Environment



Approx. distance  
from balaju bypass 2.0 KM



Rapidly  
Developing Area

**Total no of plot: 35 , Total no of under construction house: 14**

**Contact us: 9818248042**